

Adjustable Power Supply: SE-2500-12



Product Specifications:

1. Input: voltage 220V AC, Current 13 A.
2. Working frequency: 50/60Hz
3. Power: 2500W
4. Output voltage : 0 - 12V DC
5. Output current: 0 - 208 A
6. Natural air-cooled
7. LED power indicator
8. 100% full of aging
9. All use 105 °C electrolytic capacitor
10. Safety Compliance: CCC / FCC / CE
11. Working Temperature: -10 ~ 60 °C
12. Storage Temperature: -20 ~ 65 °C
13. Ambient Humidity: 20 ~ 90% RH
14. Product size: 280*180*65mm
15. Shell material: metal shell, aluminum base

Features:

1. Widely used in LED lights, industrial automation, LED display, communication, etc.
2. Protection: short circuit protection, overload protection, over voltage protection.
3. Low heat, energy saving, super safe, environmentally friendly, long service life.
4. Not waterproof: suitable for indoor use; or add waterproof case for outdoor use.
5. Orders usually ship within 24 hours after payment is received.

Control:

1. Support 0-5V (0-10V) analog signal control output voltage (linear rise)
2. Support 0-5V (0-10V) analog signal control output current (5%~100%)
3. Support adjustable resistor to control output voltage
4. Support adjustable resistor to control output current
5. Support ON/OFF remote switch machine
6. Support N+1 function
7. Professional installation of qualified electrician is highly



AC220VInput

Ground wire

Plus or minus 20% adjustable voltage

DC Output positive pole

DC output negative pole



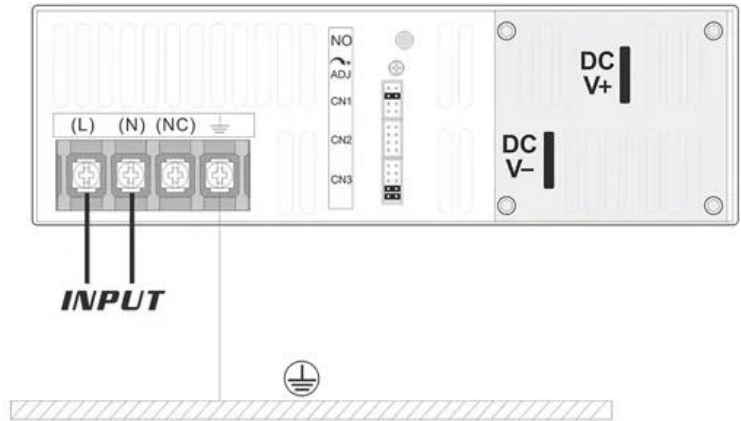

出厂默认：固定电压输出
 Factory Default: Fixed Voltage Output
 Configuración predeterminada: salida fija del voltaje
 Заводская настройка по умолчанию: фиксированное выходное напряжение
 공장 기본 상태: 고정 전압 출력

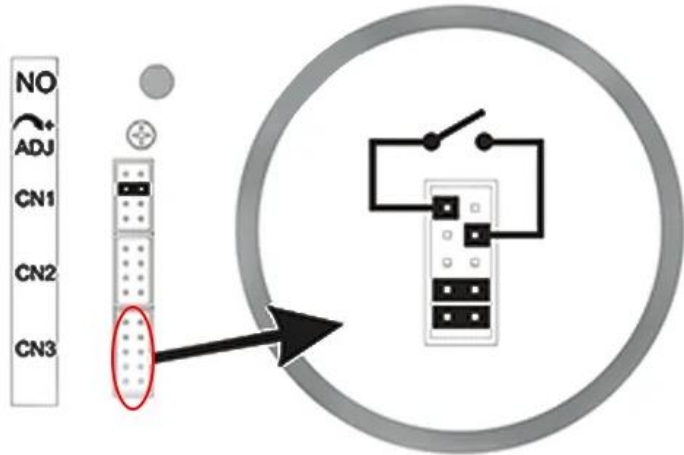

远程开关机 (ON/OFF)
 Remoto Switch(ONrOFF)
 Control remoto de encandar y apagar(ON/OFF)
 Дистанционный переключатель машины (ON / OFF)
 원격 스위치 (ON/OFF)

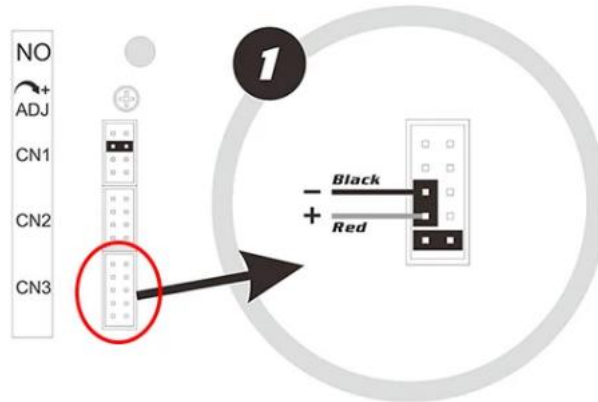

0-5V模拟信号控制输出电压(0.5V~nV)

0-5V Analog Signal Control Output Voltage (0.5V ~ nV)

Voltaje de salida (0.5V~nV) controlado por señal analógica 0-5V

0-5 В аналоговый сигнал управления выходным напряжением (0.5 ~ nВ)

0-5V 아날로그 신호 출력 전압(0.5~nV) 컨트롤

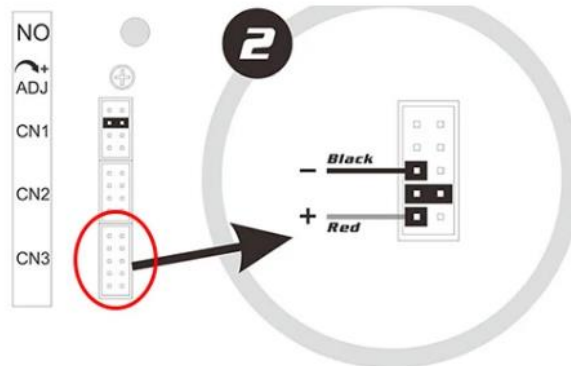

0-5V模拟信号控制输出电流(10%~nA)

0-5V Analog Signal Control Output Current (10% ~ nA)

Corriente de salida (10%~nA) controlado por señal analógica 0-5V

0-5 В аналоговый сигнал управления выходным током (10% ~ nA)

0-5V 아날로그 신호 출력 전류(10%~nA) 컨트롤

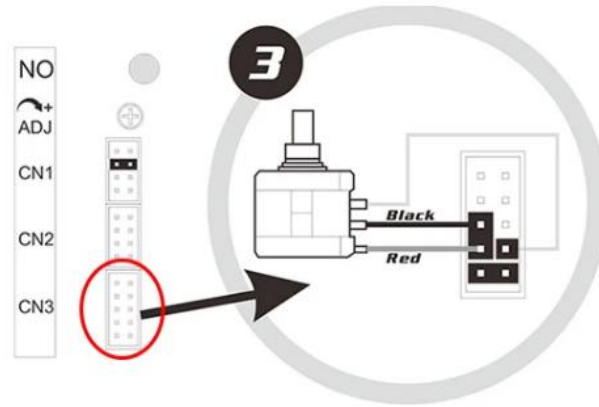

可調电阻控制输出电压(0.5~nV)

Adjustable Resistance Controlled Output Voltage (0.5 ~ nV)

Voltaje de salida (0.5~nV) controlado por resistencia ajustable

Регулируемое сопротивление для контроля выходного напряжения (0.5 ~ nВ)

가변 저항 출력 전압(0.5~nV) 제어

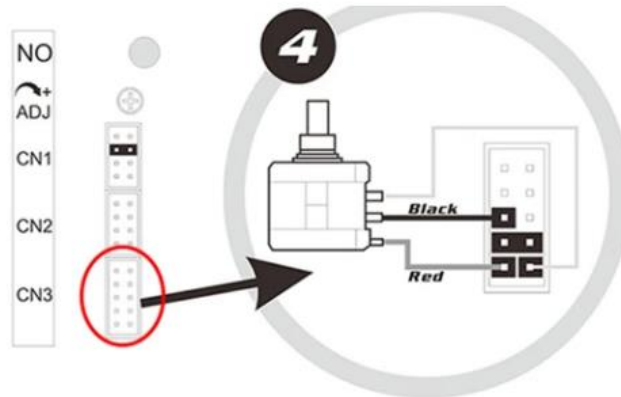

可調电阻控制输出电流(10%~nA)

Adjustable Resistance Controlled Output Current (10% ~ nA)

Corriente de salida (10%~nA) controlado por resistencia ajustable

Регулируемое сопротивление для контроля выходного тока (10%~nA)

가변 저항 출력 전류(10%~nA) 제어

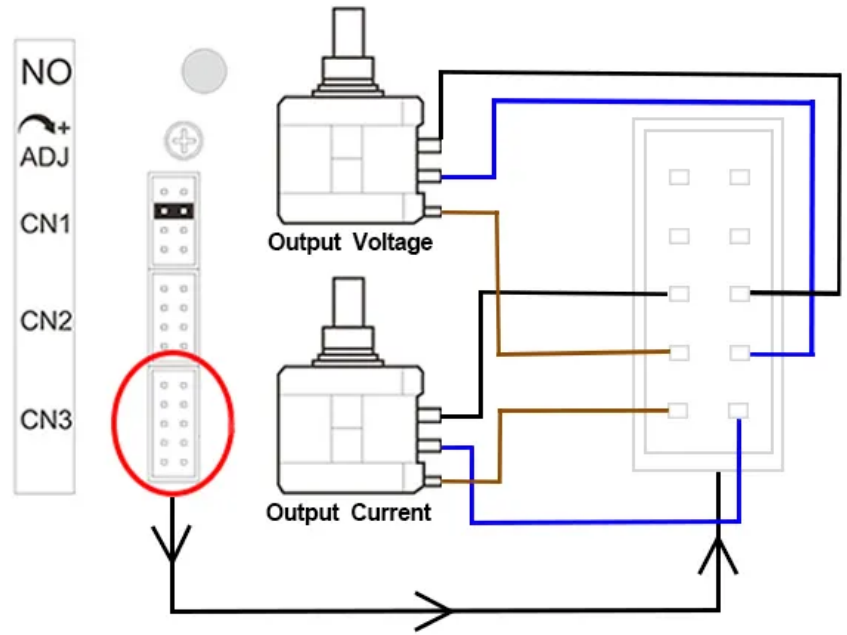

可调电阻控制输出电压(0.5~nV)

Adjustable Resistance Controlled Output Voltage (0.5 ~ nV)

Voltaje de salida (0.5~nV) controlado por resistencia ajustable

Регулируемое сопротивление для контроля выходного напряжения (0.5 ~ nВ)

가변 저항 출력 전압(0.5~nV) 제어

可调电阻控制输出电流(10%~nA)

Adjustable Resistance Controlled Output Current (10% ~ nA)

Corriente de salida (10%~nA) controlado por resistencia ajustable

Регулируемое сопротивление для контроля выходного тока (10%~nA)

가변 저항 출력 전류(10%~nA) 제어